

Rapiscan[®]
systems

An OSI Systems Company

Selling Guide for MobileCheck™ IRC



Selling Guide for Rapiscan MobileCheck™ IRC

(INTEGRATED RE-LOCATABLE CHECKPOINT)

Rapiscan MobileCheck™ IRC is a rapidly-deployable containerized checkpoint that combines the Rapiscan 620XR, the Secure 1000 Dual Pose and a Radiation Detection Monitor in easily transportable weatherproof 20 ft. ISO standard containers.

- **Rapiscan 620XR** Baggage and Parcel Inspection dual energy X-ray screening system to identify explosives, metals, contrabands and other potential threat items.
- **Rapiscan Secure 1000 Dual Pose** provides unsurpassed people screening imagery.
- **Radiation Detector** is capable of detecting gamma rays emitted from radioactive material.
- Checkpoint system includes two separate, climate-controlled containers as well as the hardware and software needed to operate the system.
- Screening operation is accomplished from a remote container up to 300 meters away**; audio/visual contact is maintained through cameras, microphones and loudspeakers (included).

Standard configuration for the Rapiscan MobileCheck™ IRC*

Each MobileCheck IRC consists of two ISO containers connected by a hardwire umbilical cord.

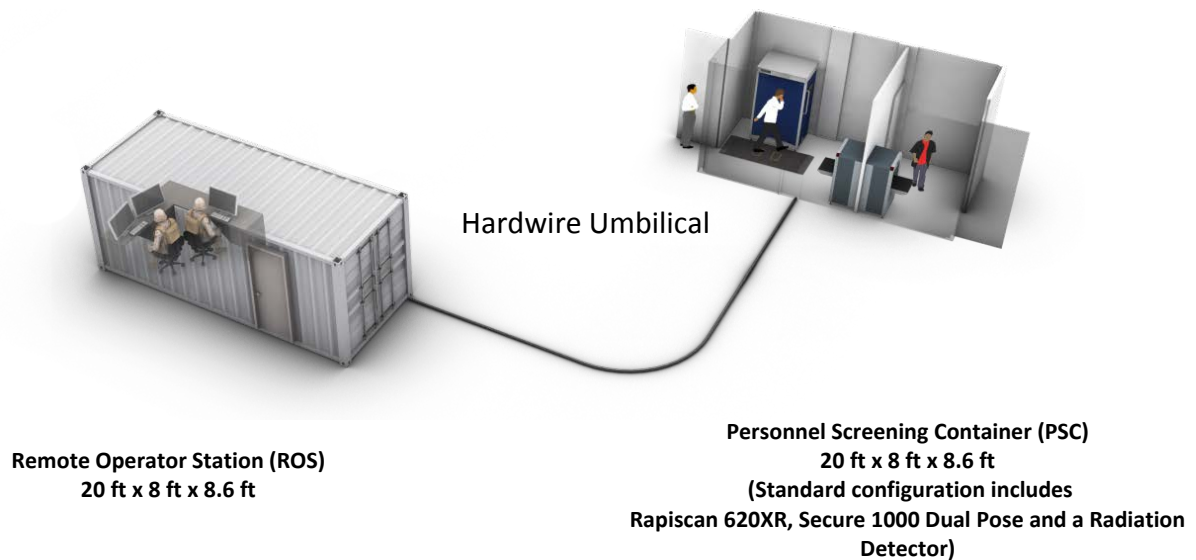

* This product has been previously marketed as Rapiscan MobileCheck™ NATO. For the purposes of this document and future marketing efforts, it will be called the Rapiscan MobileCheck™ IRC.

** For distances longer than 300 meters please submit a sales special request.

Table of Contents

Section I: Executive Summary 6

Section II: MobileCheck™ IRC Operational Overview 7

 Set up and Deployment 7

 Operation 7

Section III: Key System Features and Benefits..... 9

Section IV: Rapiscan Key Contacts and Selling Guidelines 10

 Rapiscan MobileCheck™ IRC Order Guide 10

Section V: MobileCheck™ IRC Personnel Screening Container (PSC)..... 11

 Standard Features - Physical Specifications..... 12

 Standard Features - Operational Environment and Safety..... 13

 Standard Features - Command and Control Capabilities..... 14

 Standard Features - System Hardware 14

 Standard Features - Rapiscan Secure 1000 Dual Pose..... 15

 Standard Features - Rapiscan 620XR 16

 Standard Features - FHT 1372 Radiation Detector 17

 Standard Features - Container Overview..... 18

 Standard Features - Other Features 19

 Optional Features – Stand-Alone Power Generator 20

 Optional Features – 620XR System Software 21

Section V: MobileCheck™ IRC Remote Operator Station..... 22

 Standard Features - Physical Specifications..... 23

 Standard Features - Operational Environment and Safety..... 24

 Standard Features - System Hardware 25

 Standard Features - Container Overview..... 27

 Standard Features - Other Features 28

 Optional Features - Optional Container Partition..... 28

 Optional Features - Optional Container Partition/Storage..... 29

Appendix A – Data Sheets & Additional Documentation 30

Personnel Screening Container..... 30

Remote Operator Station..... 30

Appendix B - Rapiscan MobileCheck™ Family of Products 31

Rapiscan MobileCheck™ ES (Event Security) 31

Rapiscan MobileCheck™ Secure SP..... 32

Rapiscan MobileCheck™ 636SV 32

Section I: Executive Summary

The MobileCheck™ IRC is a mobile checkpoint solution for locations and/or situations where the individual and items (i.e. baggage) being screened are the only individuals and items required to be physically present. The MobileCheck™ IRC allows for remote, non-intrusive screening from as far away as 300 meters. The system allows inspection of both personnel and hand baggage or parcels. One of the most important features of the MobileCheck is that it allows system operators to stay at a safe distance from the person being screened.

The MobileCheck™ IRC consists of (2) two 20 foot (6.1 meter), one TEU, re-locatable, climate-controlled ISO standard containers. They are connected by a hardwire umbilical cord.

The standard MobileCheck IRC system consists of two containers:

- The Personal Screening Container (PSC) is the portal where all security inspection systems are housed and screening of people and their belongings takes place.
- The Remote Operator Station (ROS) houses the operators, screening operation hardware and all the equipment and software necessary to operate the PSC remotely.

Standard screening hardware includes a Rapiscan 620XR baggage and parcel inspection system, a Secure 1000 Dual Pose whole body imaging scanner and a gamma radiation detector.

The PSC is monitored via three CCTVs, microphones and loudspeakers included in the standard configuration.

Recommended for:

- High-threat checkpoints
- Temporary security checkpoints where personnel may be at risk
- Checkpoints with limited personnel
- Temporary or semi-permanent checkpoints in inhospitable climates

MobileCheck™ is a family of security solutions designed for temporary or semi-permanent installation. For links to other MobileCheck™ products please see Appendix B.

Section II: MobileCheck™ IRC Operational Overview

Set up and Deployment

A site survey should be performed prior to deployment to ensure MobileCheck is located on level surface with adequate access to power. The MobileCheck IRC is designed to be transported in any vehicle that can accommodate a standard 20 ft ISO container. Standard operations call for use of a forklift to move the MobileCheck into final position from the transport vehicle.

Operation

The Rapiscan IRC allows security personnel to visually spot threats remotely without contact between the screened person and the Force Protection or security personnel. Individuals to be screened are viewed and communicated with via the camera/intercom system located throughout the PSC. The Command and Control operator unlocks the entrance door remotely upon individual approach. Using a microphone located at the ROS Command and Control desk, the operator advises the individual to enter the container and place bags, parcels and personal items on the 620XR conveyor belt for X-ray inspection and is given additional instruction on positioning for body scanning. The imaging systems are monitored and operated remotely by an operator who monitors the equipment from the ROS.

Bags and parcels being screened by the Rapiscan 620XR pass through the partition into the second chamber and are not returned to the individual until he or she has passed the body screening and has received permission to enter the second chamber.

If no presence of threats is indicated by the Secure 1000 DP, the Rapiscan 620XR and the radiation detector, the individual is directed through the door in the partition. The operator will unlock the partition door remotely and the individual will be instructed to retrieve his or her bag/parcel and exit through the back of the container. This operating procedure allows for high-throughput as the system can clear over 90 individuals per hour.

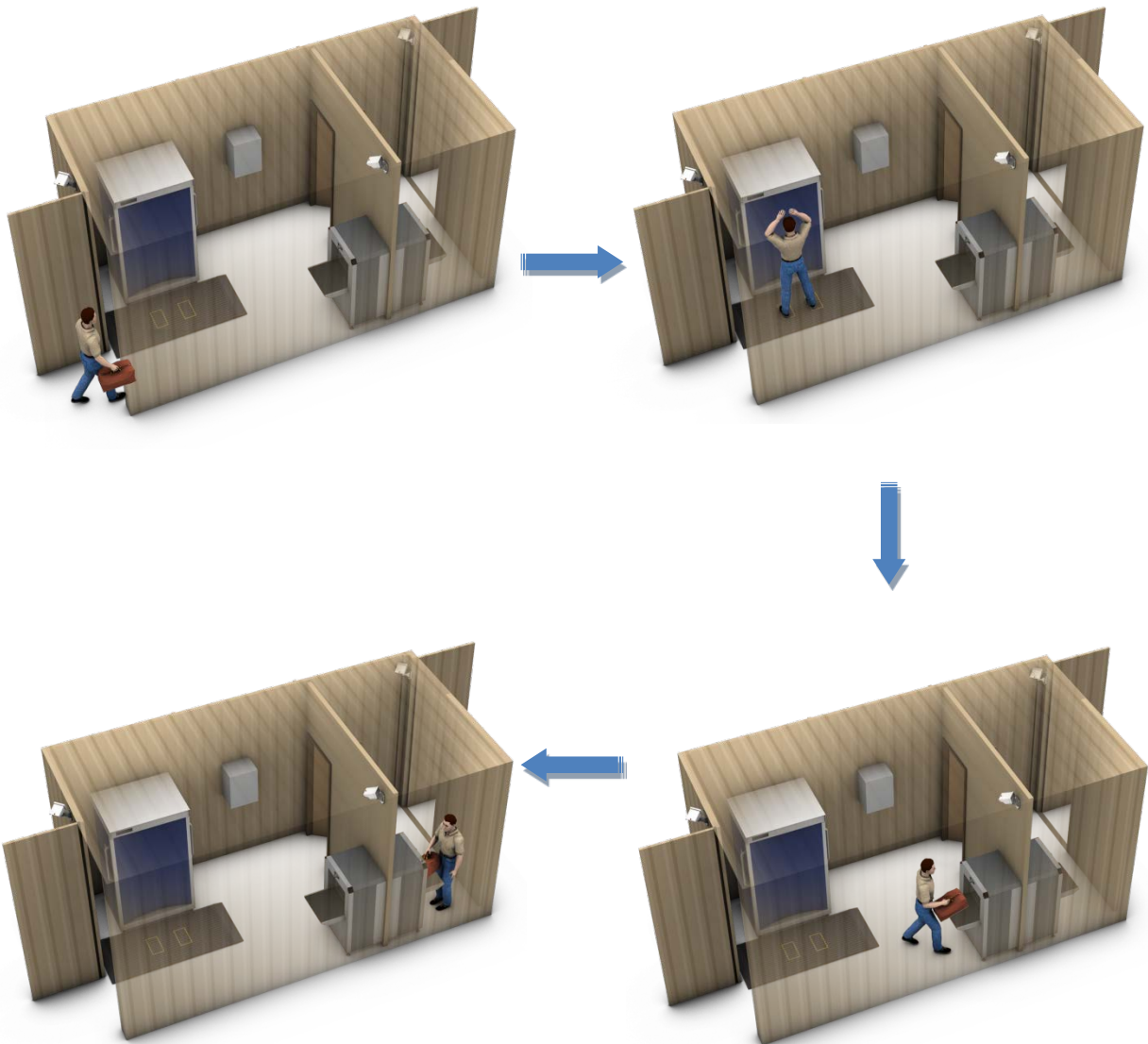

Section III: Key System Features and Benefits

The MobileCheck™ IRC is a checkpoint system especially designed for areas and situations in which protection of the screening personnel is paramount. The MobileCheck™ IRC is a system that consists a Personnel Screening Container (PSC) connected through a hardwire umbilical to the Remote Operator Station (ROS).



- The Remote Operator Station (ROS) can be located up to 300 meters away from the Personnel Screening Container (PSC) via a sheathed electrical cable (umbilical). The umbilical not only enables the operation of the Personnel Screening Container (PSC) from a safe distance, but also protects the integrity of the output data.
- Screening personnel in the Remote Operator Station (ROS) have complete command and control of the Personnel Screening Container (PSC) through a series of remotely-controlled door locks, CCTVs, loudspeakers and microphones. They are in visual contact with each PSC chamber at all times and are able to confirm that all procedures are being followed.
- The MobileCheck™ IRC system can be modified to include the Secure 1000 Single Pose, the Secure 1000 MP, a Metor metal detector, and/or a Rapiscan baggage and parcel inspection system. The MobileCheck™ IRC can be used for any security application which requires utmost safety of the screening personnel.
- The MobileCheck™ IRC Remote Operator Station (ROS) can accommodate more than two screening stations and their operators, and can be upgraded to monitor a number of screening systems such as cargo and vehicle screening. MobileCheck™ IRC provides a single solution for all security monitoring needs.

Section IV: Rapiscan Key Contacts and Selling Guidelines

The following are key Rapiscan contacts for more information regarding the MobileCheck™ IRC:

Product Management: Harry Pak
Engineering: Bally Panesar
Marketing: Hooman Shakouri
Service: Anthony Wilson

Rapiscan MobileCheck™ IRC Order Guide

The Rapiscan MobileCheck™ IRC solution comes standard with all the features described in this selling guide. The complete solution can be ordered via a single part number.

Description	Part Number
MobileCheck IRC	20251452

Any changes to the currently offered features will be considered as a custom “sales special” product. For additional information and how to request for a sales special product please contact your regional sale directors.

Section V: MobileCheck™ IRC Personnel Screening Container (PSC)

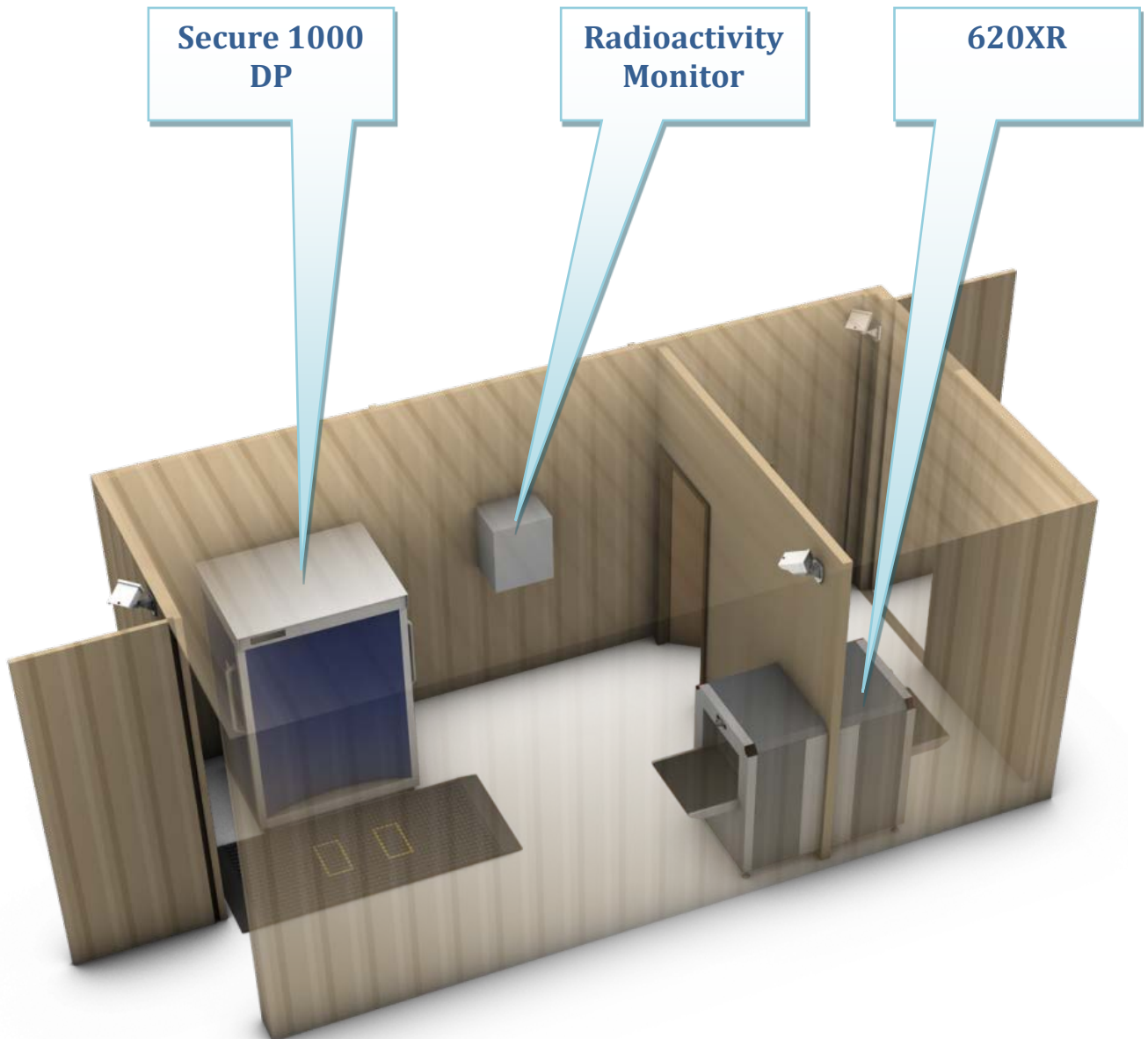

Standard Features - Physical Specifications

Rapiscan’s MobileCheck™ IRC consists of two, one TEU standard ISO containers: one Personnel Screening Container (PSC) and one Remote Operator Station (ROS). The two containers can be located up to 300 meters from each other, ensuring that the screening process does not require the physical presence of anyone other than the individual being screened.

Personnel Screening Container Physical Specifications	
Container Dimensions	One TEU standard ISO 20-foot long x 8-feet wide x 8.6-feet high insulated container with doors at both ends.
Weight	12,000 lbs. (5443.1 Kg)
Container Color and Finish	Mid-blue. Semi gloss: Marine specification
Container Floor	150mm x 50mm PSC bottom rails with graded floor bearers of 100mm x 50mm PSC. Flooring is 30mm Finnish plywood, treated to IM/Radaleum FHP-602010, screwed to steel floor bearers and finished in a 2.0mm heavy duty Polysafe anti-slip vinyl flooring with hot seam welded joints.
Container Walls and Roof	Manufactured to ISO specification and walls tested to 0.5P from standard profile exterior MS Sheets to 1.6m. Internally, the unit will be lined with 18mm particulate wallboards with light grey vinyl finish to walls and ceiling, fixed to softwood 50x50mm CLS timber framework and insulated with 50mm Kingspan Therma high density insulation boards. All joints capped with white T-section and silicon sealed.
Internal Doors and Partitions	Metal clad fire doors 1000 and 850mm. 5 point locking internal partitions. Constructed from 50x50mm CLS softwood timber studding lined both sides with 18mm particle board with vinyl coating in light grey. All joints capped and sealed. Insulated with Kingspan Terma 50mm.
Electrical Installation and Fittings	Unit includes sheathed electrical cable connected to consumer unit fitted with circuit breakers. Installation will be complainant with IEEE regulations and fully tested prior to dispatch with test certificate. (1) 6-way RCCD consumer unit (2) 13 amp twin switched double sockets to suit specification. (2) brushed stainless steel “L” brackets to provide stability to the AMD Wiring to the 17 th Edition, UK or US sockets, number and type advised at build, CAT 2 lighting.
Container Fixtures and Fittings	(4) Lifting points, situated at top and bottom of each corner post. (2) Forklift lifting pockets (67 inches wide). (1) 4” dado trunking

Standard Features - Operational Environment and Safety

Rapiscan MobileCheck™ IRC is designed to facilitate smooth equipment operation as well as personnel comfort. Below is the safety equipment that is standard in the Personnel Screening Container (PSC), including smoke alarms, fire extinguishers and exterior floodlights.

Personnel Screening Container Operational Environment and Safety	
Item	Description
Container Climate	Insulated container with (2) wall-mounted air conditioner/heating units. Airforce 17 in the scanning chamber is a 17,000 BTU system; Airforce 12 in the exit chamber is a 12,000 BTU system.
Storage Temperature	Rapiscan 620XR: -20°C to 50°C Rapiscan Secure 1000: 0°C to 50°C Radiation Detector: 0 °C to 40 °C
Operating Temperature	Rapiscan 620XR: 0°C to 40°C Rapiscan Secure 1000: 0°C to 40°C Radiation Detector: 0 °C to 40 °C
Relative Humidity	Rapiscan 620XR: 5% to 95% non-condensing Rapiscan Secure 1000: 5% to 95% non-condensing Radiation Detector: 10% to 80%, non-condensing
Screening Systems – Standard Configuration	Rapiscan 620XR X-ray Baggage and Parcel Inspection System Rapiscan Secure 1000 Dual Pose Personnel Screening System FHT 1372 Gamma Radiation Detector
Fire Safety	Two (2) smoke detectors/alarms, hardwired with battery backup Two (2) fire extinguishers; one in each chamber
Lighting	Exterior – (2) 400W SON Floodlights, rated IP 65, with lamp. Recommended for medium to large areas with long-duration, round the clock floodlighting. Interior – low profile interior lighting to 500 LUX with emergency backup, exit lights.

Standard Features - Command and Control Capabilities

Rapiscan MobileCheck™ IRC includes a number of features that ensure effective command and control. MobileCheck™ IRC systems provide state of the art communication equipment for the remote operator and enables safe and accurate two-way communication between remote operators and individual being screened.

Personnel Screening Container Command and Control Capabilities	
Audio	2-way audio is provided through the integrated microphone and speaker on the three M22 Mobotix closed circuit cameras – one outside, one in each compartment of the Personnel Screening Container. Logitech X-140 speakers are used to support two way audio communication between the personnel screening container and the remote operator container.
Visual	Three (3) M22 Mobotix closed circuit cameras which can be mounted indoors or outdoors without fear of extreme weather. Rated IP 65, this single lens camera requires no additional enclosures. The camera is equipped with a variable focus lens for onsite adjustments.
Locks	Two (2) remotely operated magnetic door locks for entrance and partition doors. The locks have a holding force of 500Kg, and include lock status monitoring.

Standard Features - System Hardware

Rapiscan MobileCheck™ IRC includes standard screening systems as listed below. See page XX for related hardware to fit a variety of secure screening needs in situations where protection of security personnel is paramount.

Personnel Screening Container System Hardware	
Item	Description
Baggage and parcel Inspection	Rapiscan 620XR 140KV, with 0.5 M output roller and updated OS 600 operating software
People screening	Rapiscan Secure 1000 Dual Pose
Radioactivity Monitor	FHT 1372 Gamma Radiation Detector

Standard Features - Rapiscan Secure 1000 Dual Pose

The following are photographs and illustration of the Rapiscan Secure 1000 Dual Pose people screener which is a standard MobileCheck™ IRC feature.



Rapiscan Secure 1000 Dual Pose

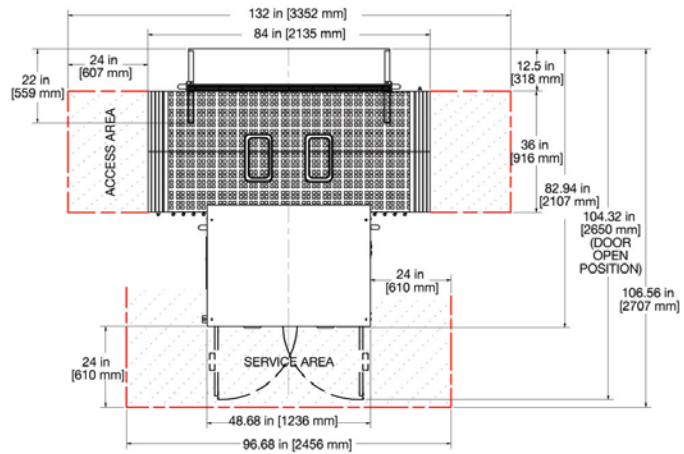
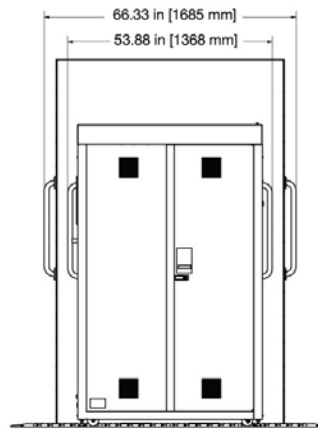

Standard Features - Rapiscan 620XR

The following are photographs and illustration of the Rapiscan 620XR baggage and parcel inspection system which is a standard MobileCheck™ IRC feature.

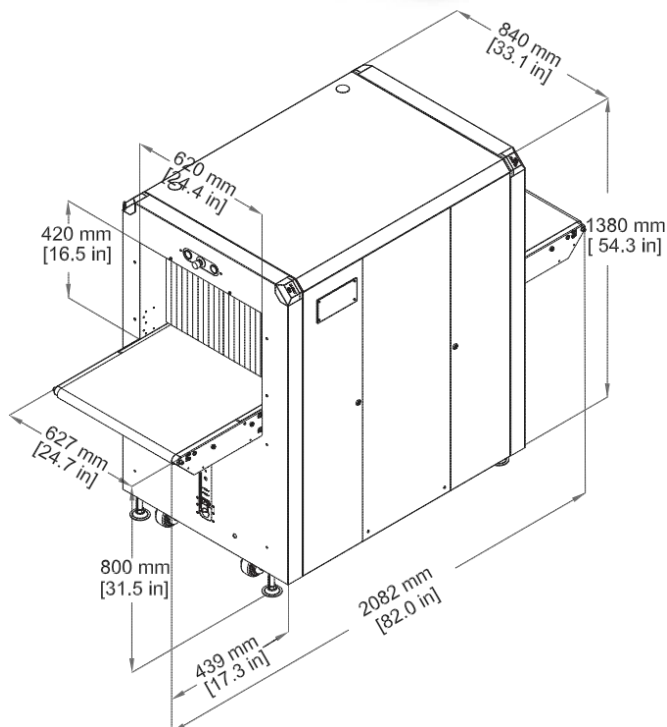

Rapiscan Systems sales team proprietary and confidential information – not for outside distribution.

Standard Features - FHT 1372 Radiation Detector

The following is a photograph of the FHT 1372 Radioactivity Monitor.



Standard Features - Container Overview

The following are illustrations of the standard MobileCheck™ IRC People Screening Container.

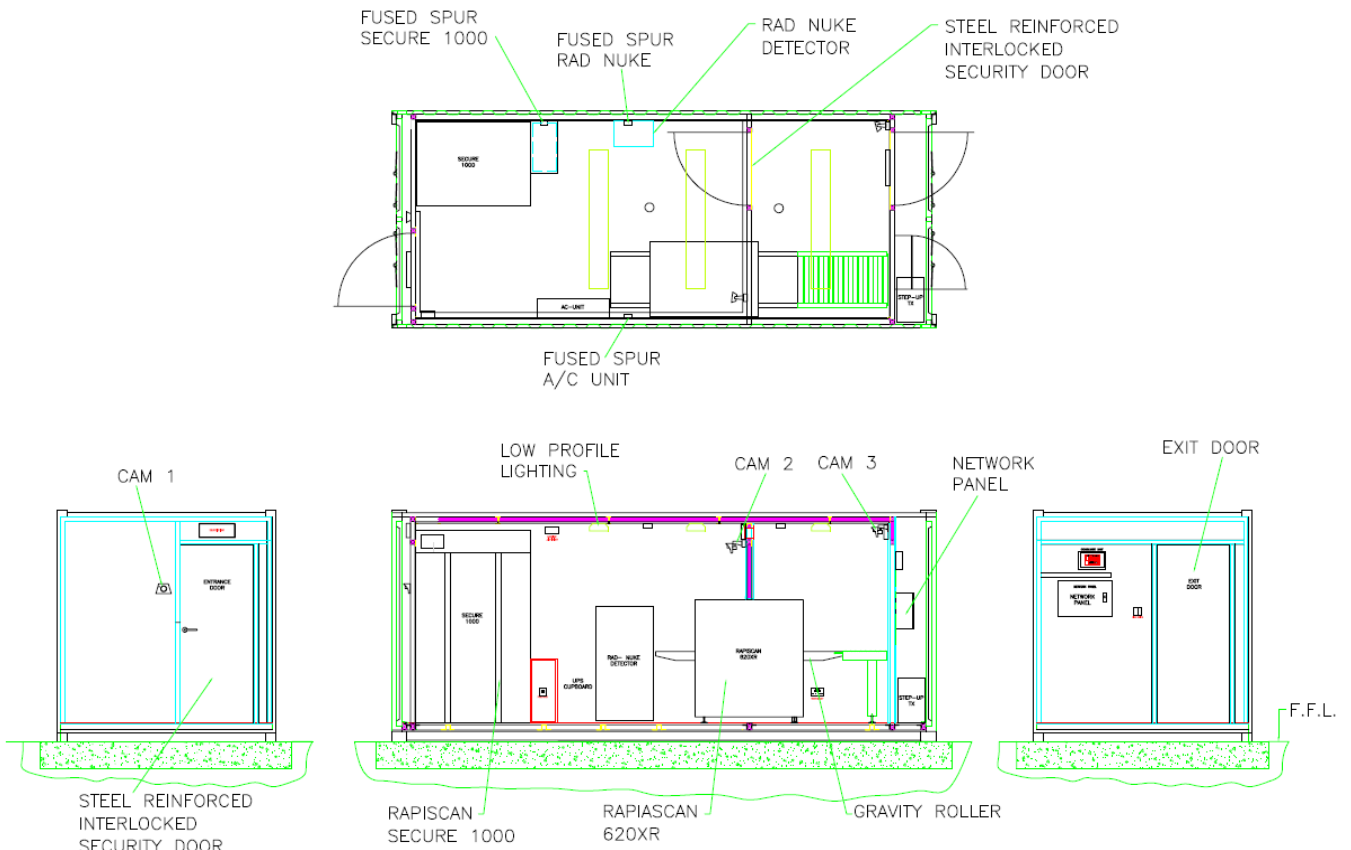

Standard Features - Other Features

The following are photographs of standard MobileCheck™ IRC features, including floodlights, closed-circuit cameras and air conditioning/heating systems.



400W SON Floodlight



**Mobotix M22 Indoor/Outdoor
Closed Circuit Camera**

Optional Features – Stand-Alone Power Generator

The following is a photograph of the recommended diesel generator which is an optional MobileCheck™ IRC feature.

FG Wilson Diesel Generator is a stand-alone generator with enclosure and backup Model P27P1 and P30P1. This generator is designed to operate on continuous power in ambient temperatures up to 50°C.

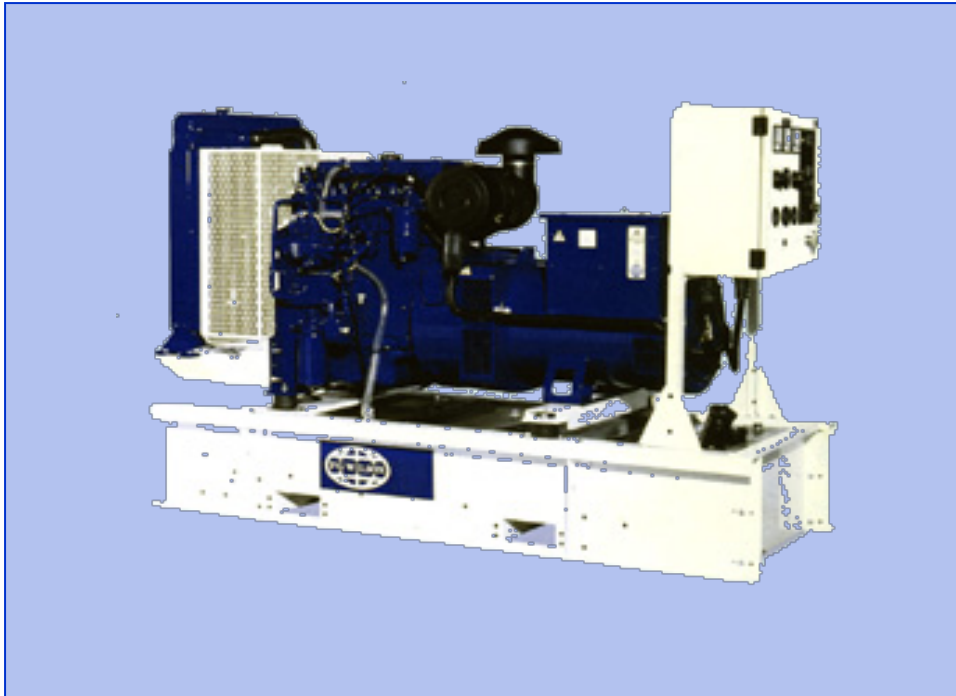

Optional Features – 620XR System Software

The software systems below are optional features available for all Rapiscan 600 series baggage and parcel inspection systems.

Personnel Screening Container 620XR Optional Features	
Description	Part Number
TIP Software (must be ordered with a TIP Library)	SW930163
TIP Library	
Qty: 198 Images	SW930164
Qty: 1000 Images	SW930289-1
Qty: 2000 Images	SW930289-2
Qty: 3000 Images	SW930289-3
Qty: 4000 Images	SW930289-4
Qty: 5000 Images	SW930289-5
Target™	SW930193
iTarget (Interactive Target™)	SW930227
Automatic Image Archiving	SW930195
DTA – Density Threshold Alert	SW930194
Manual Scan	SW930236
OTP – Operator Training Program	SW930240
TIPNET – Threat Image Projection Network (Additional Hardware required)	SW930229
TMAS - TIP Management and Analysis System (Standalone)	SW930232
SmartCard Reader (Additional Hardware required)	SW930241
NDS – Network Display Station (Additional Hardware required)	SW930237
Laser Printer Kit (Additional Hardware required)	SW930242

Section V: MobileCheck™ IRC Remote Operator Station

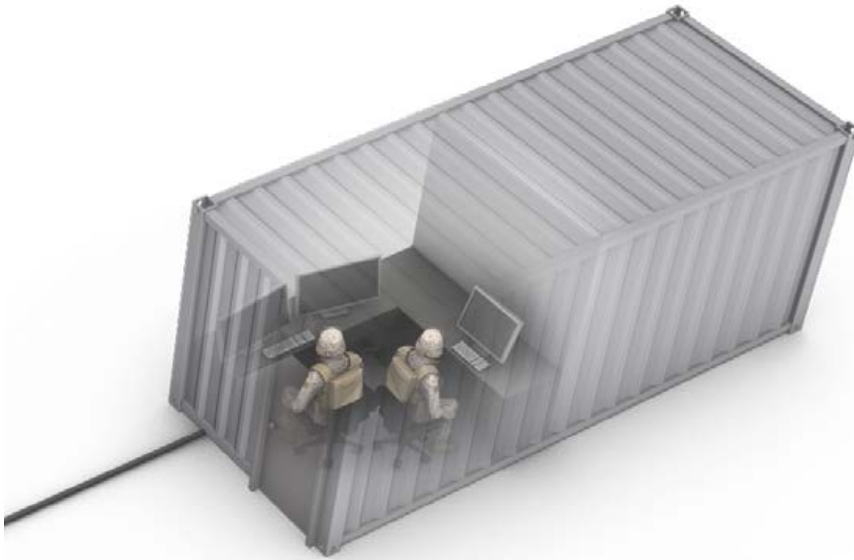

Standard Features - Physical Specifications

Rapiscan’s MobileCheck™ IRC consists of two ISO containers: one Personnel Screening Container and one Remote Operator Station. Because of the hardwire umbilical connection, the two containers can be located up to 300 meters from each other, ensuring that the screening process does not require the physical presence of anyone other than the individual being screened. Below are the standard physical specifications of the Remote Operator Station.

Remote Operator Station Physical Specifications	
Item	Description
Container Dimensions	One TEU Standard ISO 20-foot long x 8-foot wide x 8.6-foot high insulated container with doors at both ends.
Container Weight	6,000 pounds (2721.6 Kg)
Container Color and Finish	Mid-blue. Semi gloss: Marine specification
Container Floor	150mm x 50 mm PSC bottom rails with graded floor bearers of 100mm x 50mm PSC. Flooring is 30mm Finnish plywood, treated to IM/Radaleum FHP-602010, screwed to steel floor bearers and finished in a 2.0mm heavy duty Polysafe anti-slip vinyl flooring with hot seam welded joints.
Container Walls and Roof	Manufactured to ISO specification and walls tested to 0.5P from standard profile exterior MS Sheets to 1.6m. Internally, the unit will be lined with 18mm particulate wallboards with light grey vinyl finish to walls and ceiling, fixed to softwood 50x50mm CLS timber framework and insulated with 50mm Kingspan Therma high density insulation boards. All joints capped with white T-section and silicon sealed.
Door	Metal clad fire doors with 5-point locking system.
Electrical Installation and Fittings	Unit includes sheathed electrical cable connected to consumer unit fitted with circuit breakers. Installation will be complainant with IEE regulations and fully tested prior to dispatch with test certificate. Unit includes: (1) 6-way RCCD consumer unit (2) 13 amp twin switched double sockets to suit specification. (2) brushed stainless steel “L” brackets to provide stability to the AMD Wiring to the 17 th Edition, UK or US sockets, number and type advised at build, CAT 2 lighting.
Container Fixtures and Fittings	(4) Lifting points, situated at top and bottom of each corner post. (2) Forklift lifting pockets (67 inches wide). (1) 4” dado trunking

Standard Features - Operational Environment and Safety

Rapiscan MobileCheck™ IRC is designed to facilitate smooth equipment operation as well as personnel comfort. Below is the safety equipment that is standard in the Remote Operator Station, including smoke alarm, fire extinguisher and exterior floodlights.

Personnel Screening Station	
Operational Environment and Safety	
Item	Description
Container Climate	Insulated container with (1) Airforce 24 wall-mounted air conditioner/heating unit of 24,000 BTUs
Storage Temperature	Dell Optiplex 780 Minitower: -40° to 65° C Dell Ultrasharp U2410 Monitor: -20° to 60° C Dell 3130cn Duplex Color Laser Printer: 0° to 35° C
Operating Temperature	Dell Optiplex 780 Minitower: 10° to 35° C Dell Ultrasharp U2410 Monitor: 0° to 40° C Dell 3130cn Duplex Color Laser Printer: 5° to 35° C
Relative Humidity	Dell Optiplex 780 Minitower: 20% to 80% non-condensing Dell Ultrasharp U2410 Monitor: 5% to 90% non-condensing Dell 3130cn Duplex Color Laser Printer: 15% to 85% non-condensing
Fire Safety	One (1) smoke detector/alarm – hardwired with battery backup; one (1) fire extinguisher
Lighting	Exterior – (2) 400W SON Floodlights, rated IP65, with lamp. Recommended for medium to large areas with long-duration, round the clock floodlighting. Interior – low profile interior lighting to 500 LUX with emergency backup, exit lights.

Standard Features - System Hardware

Rapiscan MobileCheck™ IRC includes standard computer workstations and peripherals as listed below.

Remote Operator Station System Hardware	
Remote Workstation for Rapiscan 620XR	Dell Optiplex 780 Minitower CPU (X0878001), Dell Ultrasharp 24-inch U2410 widescreen flat panel monitor keyboard and mouse.
Remote Workstation for Secure 1000 Dual Pose	Dell Optiplex 780 Minitower CPU (X0878001), Dell Ultrasharp 24-inch U2410 widescreen flat panel monitor keyboard and mouse.
Command and Control Work Station	Dell Optiplex 780 Minitower CPU (X0878001), Dell Ultrasharp 24-inch U2410 widescreen flat panel monitor keyboard and mouse. Logitech microphone with USB connection. Monitor will show all three views simultaneously – outside, chamber one and chamber two in the Personnel Screening Container.
Color Laser Printer	Dell 3130cn Duplex Color Laser Printer

The following are photographs of the standard computer workstations and peripherals included in the Rapiscan MobileCheck™ IRC Remote Operator Station.

Remote Operator Station System Hardware



**Dell Optiplex 780
Mini Tower**



**Dell Ultrasharp U 2410
Monitor**



**Dell Color Laser Printer
3130cn**

Standard Features - Container Overview

The following are illustrations of the standard MobileCheck™ IRC Remote Operator Station.

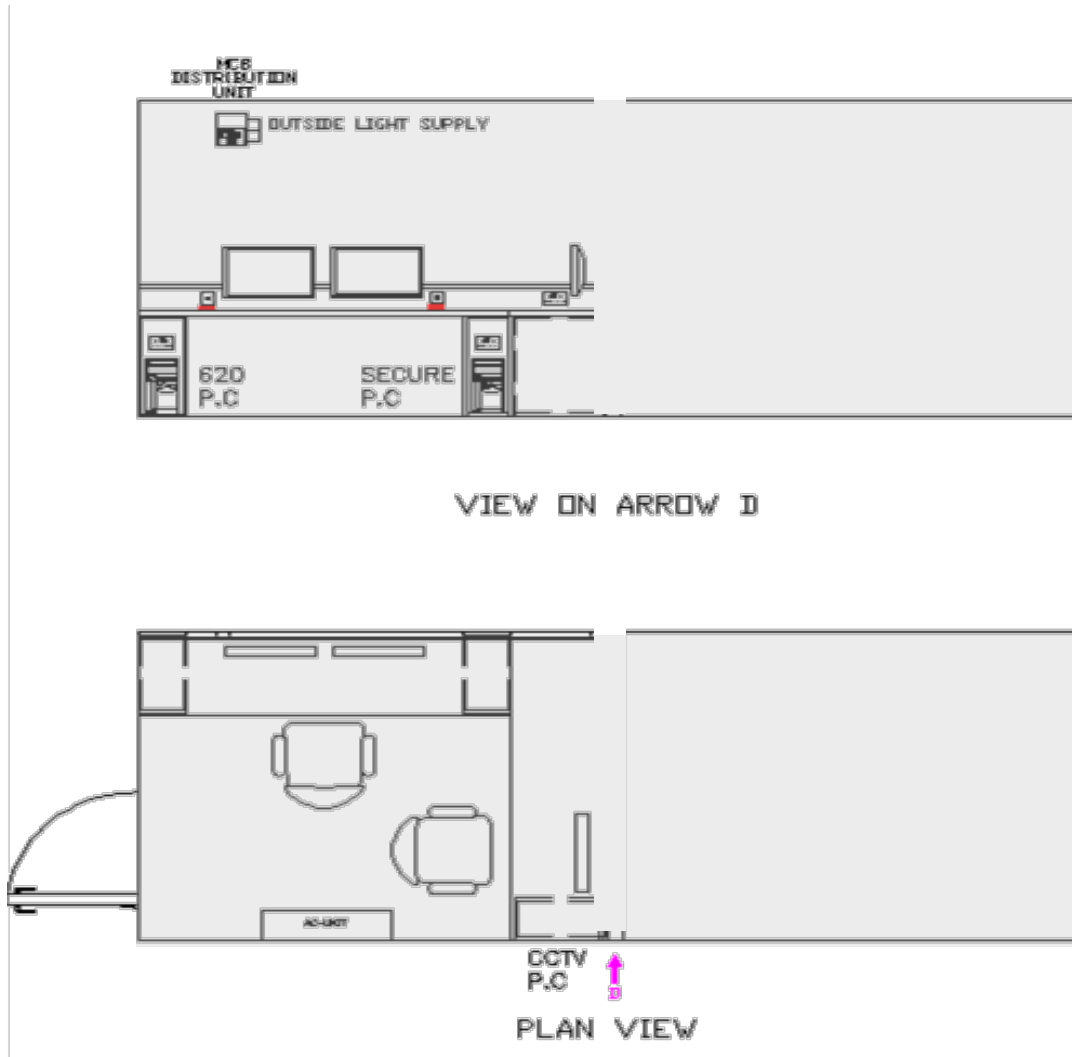

Standard Features - Other Features

The following are photographs of standard MobileCheck™ IRC features, including floodlights, closed-circuit cameras and air conditioning/heating systems.



400W SON Floodlight



Robotix M22 Indoor/Outdoor Closed Circuit Camera

Optional Features - Optional Container Partition

The following is a description of the optional container partition available for the MobileCheck™ IRC Remote Operator Station.

Remote Operator Station Optional Container Partition	
Item	Description
Partition	The Remote Operator Station can be <u>permanently</u> divided into two chambers, allowing the second chamber to include storage cabinets or open storage. The partition is constructed from 50mmx50mm CLS softwood timber studding lined both sides with 18mm particle board with vinyl coating in light grey. All joints capped and sealed. Insulated with Kingspan Terna 50mm.
Fire Safety	One (1) smoke detector/alarm – hardwired with battery backup; one (1) fire extinguisher

Optional Features - Optional Container Partition/Storage

The following is an illustration of the optional container partition available for the MobileCheck™ IRC Remote Operator Station.

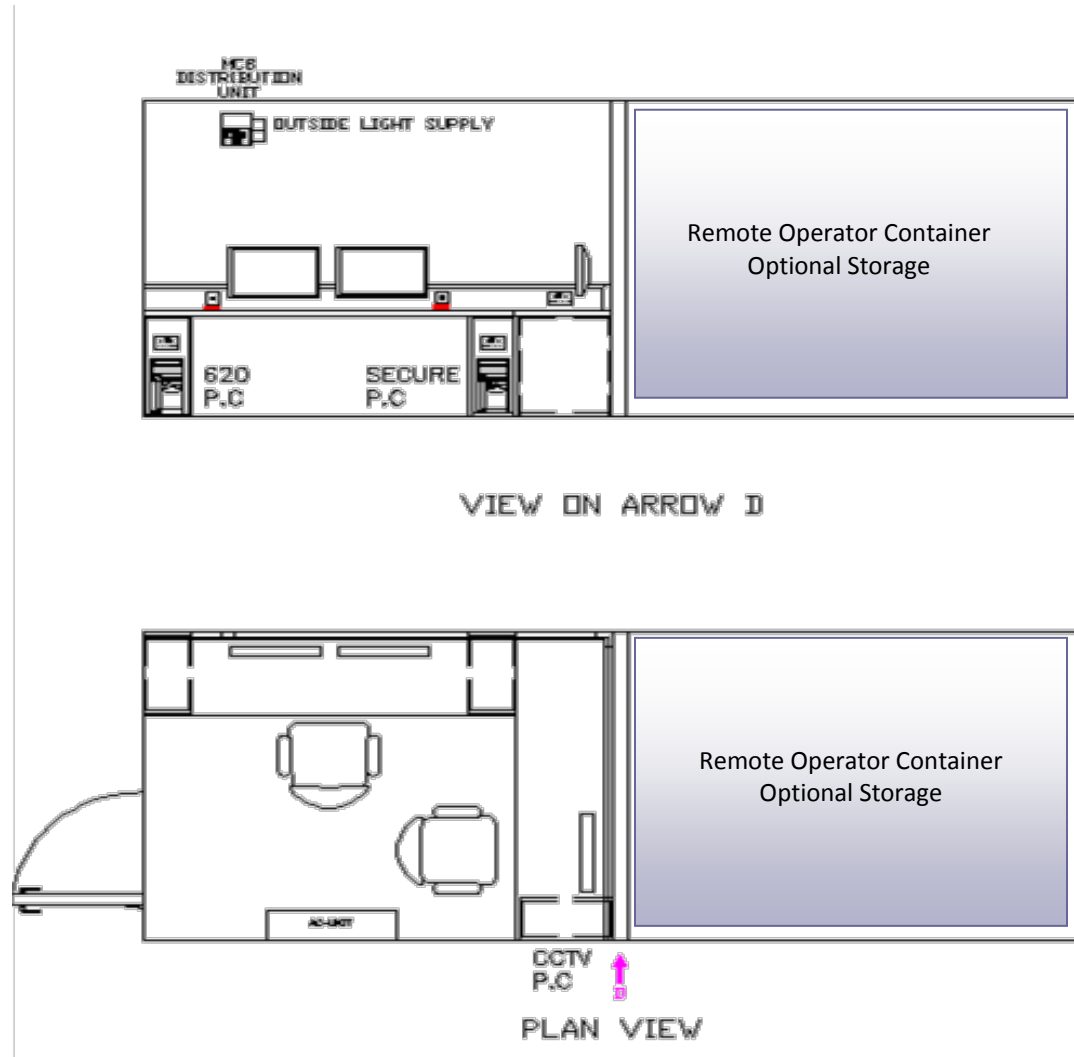

Appendix A – Data Sheets & Additional Documentation

Below is a list of additional documentation available for systems and components that are part of the MobileCheck IRC. Please click on the hyperlink to access the documentation.

Personnel Screening Container

[Rapiscan 620XR](#)

[Rapiscan Secure 1000 Dual Pose](#)

[Radioactive Material Detector](#)

[Mobotix M22 High Resolution, Variable Focus Camera](#)

[400W SON Floodlight with Lamp](#)

[Newlec Smoke Detector/Alarm, w/ Battery Backup, Ionisation, 220-240V AC](#)

[Remotely Controlled Door Locks](#)

[Air Conditioning Unit](#)

[Rapiscan Secure 1000 Single Pose \(optional\)](#)

[FG Wilson Generator with Enclosure \(optional\)](#)

Remote Operator Station

[Dell Optiplex 780 MiniTower \(3\)](#)

[Dell Ultrasharp U2410 Color Monitor \(3\)](#)

[Dell 3130cn Duplex Color Laser Printer \(1\)](#)

[Mobotix M22 High Resolution, Variable Focus Camera](#)

[400W SON Floodlight with Lamp](#)

[Newlec Smoke Detector/Alarm, w/ Battery Backup, Ionisation, 220-240V AC](#)

Appendix B - Rapiscan MobileCheck™ Family of Products

Rapiscan MobileCheck™ ES (Event Security)

The Rapiscan MobileCheck™ ES provides a mobile, relocatable checkpoint security solution for events, critical buildings and temporary or semi-permanent entryways. The standard, 20 ft. container integrates the Rapiscan 620XR X-ray baggage screening system with the Meteor 300 walk-through metal detector to screen people and baggage for threats and contraband.

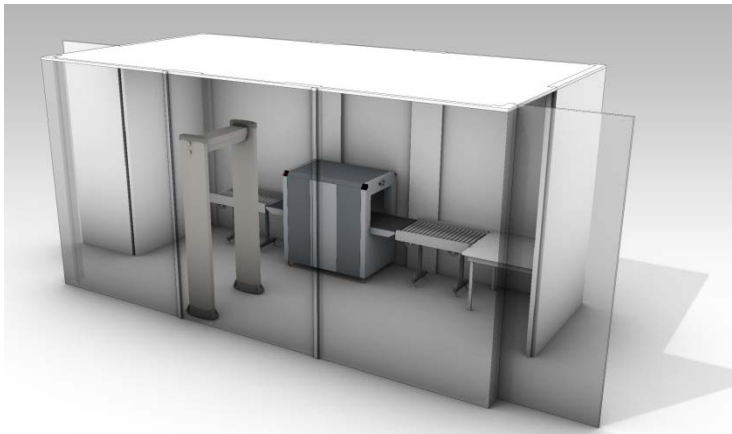

MobileCheck™ ES 001



MobileCheck™ ES 002

Rapiscan MobileCheck™ Secure SP

Rapiscan's MobileCheck™ Secure SP is a containerized whole body imaging solution for hard to reach, temporary or semi-permanent checkpoint needs. It includes the superior threat detection ability of the Secure 1000 Single Pose screening system in a 10 foot shipping container that is easily deployable in nearly any terrain.

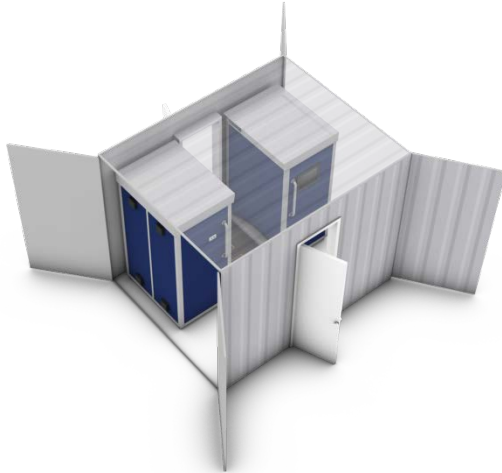

MobileCheck™ Secure SP

Rapiscan MobileCheck™ 636SV

The Rapiscan MobileCheck™ 636SV is a state of the art self-contained mobile X-ray screening unit with a large tunnel opening of 1,000mm (40in) by 1,000mm (40in).

With an innovative design, it is now possible to rapidly deploy baggage and parcel inspection at any location with one complete unit. The Rapiscan MobileCheck 636SV can be deployed and operated in three different modes, from either side of the van or in a pass through mode.



MobileCheck™ 636SV